

8" Light Cross Section Elematic Hollow Core Plank

Load Table **Maximum Uniformly Distributed Load (psf)**

Strand Pattern	Strand Area(in ²)	Clear Span (Feet)															
		15	16	17	18	19	20	21	22	23	24	25	26	27	28	29	
8S78-1.75	1.071	370	344	322	301	283	267	252	239	227	213	193	175	159	145	132	
8S58-1.75	0.765	336	312	291	273	256	231	205	183	164	147	132	119	107	97	87	
8S48-1.75	0.612	318	296	266	233	205	181	160	142	126	112	100	89	80	71	63	

Estimated Camber at Time of Erection (inches)

Strand Pattern	Strand Area(in ²)	Clear Span (Feet)															
		15	16	17	18	19	20	21	22	23	24	25	26	27	28	29	
8S78-1.75	1.071	0.43	0.48	0.52	0.57	0.61	0.65	0.69	0.73	0.76	0.78	0.80	0.82	0.82	0.81	0.80	
8S58-1.75	0.765	0.28	0.31	0.34	0.36	0.38	0.40	0.41	0.42	0.42	0.41	0.40	0.38	0.35	0.31	0.25	
8S48-1.75	0.612	0.21	0.23	0.24	0.25	0.26	0.27	0.27	0.26	0.25	0.23	0.20	0.16	0.11	0.05	0.0	

$A_c =$	195.5 in ²
$b_w =$	10.19 in
$I_g =$	1586 in ⁴
$y_b =$	4.08 in
$w_t =$	52 psf
$f'_{ci} =$	4000 psi
$f'_c =$	7000 psi
$f_{pu} =$	270 ksi

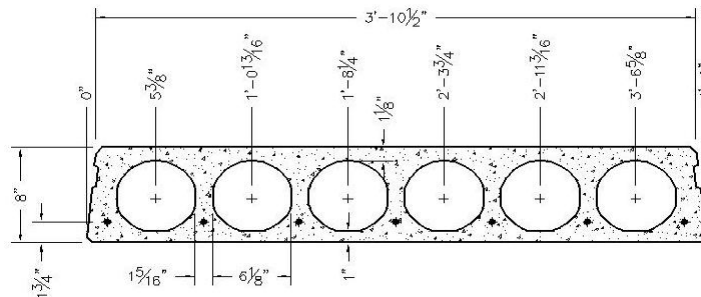

Notes:

1. Tabulated safe uniform distributed loads in this table are based on ACI 318-02/318R-02.
2. All calculated loads are considered as superimposed live load based on 1.2DL + 1.6LL.
3. Topping weight is not included in tabulated values. Size and location of openings may effect table capacity.
4. All prestressing strand is stressed to 70% of f_{pu} .
5. Tabulated loads in the shaded region have live load deflections greater than $L/360$.
6. Plank is 1 hour fire rated per IBC 2003. For higher ratings please contact KP.
7. For longer spans or conditions not covered by this table please contact KP.

Issue date: 8/10/07