

## 10" Light Cross Section Elematic Hollow Core Plank

**Load Table** Maximum Uniformly Distributed Load (psf)

Strand Pattern	Strand Area(in <sup>2</sup> )	Clear Span (Feet)											
		24	26	28	30	32	34	36	38	40	42	44	46
10S108-1.75	1.530	318	290	265	244	216	184	156	133	113	96	82	69
10S88-1.75	1.224	294	267	236	199	169	143	121	101	85	70	-	-
10S68-1.75	0.918	251	206	171	142	118	99	83	69	-	-	-	-
10S48-1.75	0.612	156	125	101	81	65	-	-	-	-	-	-	-

**Estimated Camber at Time of Erection (inches)**

Strand Pattern	Strand Area(in <sup>2</sup> )	Clear Span (Feet)											
		24	26	28	30	32	34	36	38	40	42	44	46
10S108-1.75	1.530	0.94	1.04	1.13	1.21	1.27	1.29	1.29	1.25	1.16	1.03	0.83	0.57
10S88-1.75	1.224	0.69	0.75	0.80	0.83	0.83	0.80	0.74	0.63	0.48	0.27	-	-
10S68-1.75	0.918	0.45	0.46	0.46	0.44	0.39	0.30	0.18	0.01	-	-	-	-
10S48-1.75	0.612	0.20	0.18	0.13	0.06	-0.05	-	-	-	-	-	-	-

$$\begin{aligned}
 A_c &= 244 \text{ in}^2 \\
 b_w &= 10.63 \text{ in} \\
 I_g &= 3080 \text{ in}^4 \\
 y_b &= 5.1 \text{ in} \\
 w_t &= 65 \text{ psf} \\
 f'_{ci} &= 5000 \text{ psi} \\
 f'_c &= 7000 \text{ psi} \\
 f_{pu} &= 270 \text{ ksi}
 \end{aligned}$$

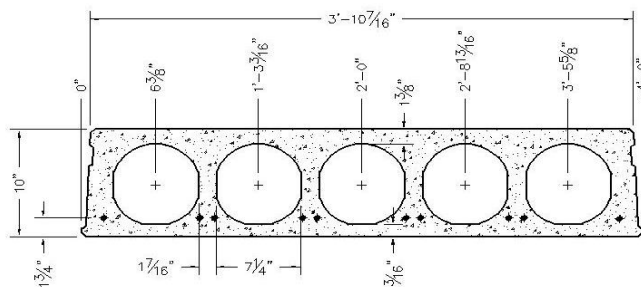

**Notes:**

1. Tabulated safe uniform distributed loads in this table are based on ACI 318-02/318R-02.
2. All calculated loads are considered as superimposed live load based on 1.2DL + 1.6LL.
3. Topping weight is not included in tabulated values. Size and location of openings may effect table capacity.
4. All prestressing strand is stressed to 70% of  $f_{pu}$ .
5. Tabulated loads in the shaded region have live load deflections greater than  $L/360$ .
6. Plank is 1 hour fire rated per IBC 2003. For higher ratings please contact KP.
7. For longer spans or conditions not covered by this table please contact KP.

Issue date: 8/10/07