

Load Table

Maximum Uniformly Distributed Load (psf)

Strand Pattern	Strand Area(in ²)	Clear Span (Feet)											
		24	26	28	30	32	34	36	38	40	42	44	46
10S108-1.75	1.530	318	290	265	244	216	184	156	133	113	96	82	69
10S88-1.75	1.224	294	267	236	199	169	143	121	101	85	70	-	-
10S68-1.75	0.918	251	206	171	142	118	99	83	69	-	-	-	-
10S48-1.75	0.612	156	125	101	81	65	-	-	-	-	-	-	-

Estimated Camber at Time of Erection (inches)

Strand Pattern	Strand Area(in ²)	Clear Span (Feet)											
		24	26	28	30	32	34	36	38	40	42	44	46
10S108-1.75	1.530	0.94	1.04	1.13	1.21	1.27	1.29	1.29	1.25	1.16	1.03	0.83	0.57
10S88-1.75	1.224	0.69	0.75	0.80	0.83	0.83	0.80	0.74	0.63	0.48	0.27	-	-
10S68-1.75	0.918	0.45	0.46	0.46	0.44	0.39	0.30	0.18	0.01	-	-	-	-
10S48-1.75	0.612	0.20	0.18	0.13	0.06	-0.05	-	-	-	-	-	-	-

- A_c = 244 in²
- b_w = 10.63 in
- I_g = 3080 in⁴
- y_b = 5.1 in
- w_t = 65 psf
- f'_{ci} = 5000 psi
- f'_c = 7000 psi
- f_{pu} = 270 ksi

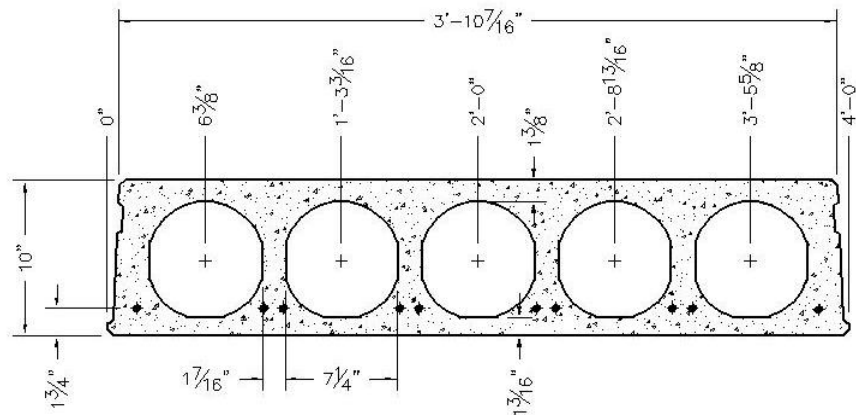

Notes:

1. Tabulated safe uniform distributed loads in this table are based on ACI 318-02/318R-02.
2. All calculated loads are considered as superimposed live load based on 1.2DL + 1.6LL.
3. Topping weight is not included in tabulated values. Size and location of openings may effect table capacity.
4. All prestressing strand is stressed to 70% of f_{pu}.
5. Tabulated loads in the shaded region have live load deflections greater than L/360.
6. Plank is 1 hour fire rated per IBC 2003. For higher ratings please contact KP.
7. For longer spans or conditions not covered by this table please contact KP.



1330 Chicago Drive, Jenison, Michigan 49428
 616.224.6176 1816.224.2851 www.kerkstra.com



ENG:
PLANT:
FIELD:
PRES:

10" LIGHT CROSS SECTION ELEMATIC HOLLOW CORE PLANK	
DATE: 1/12/10	FILE NAME: 1305