

Load Table

Maximum Uniformly Distributed Load (psf)

Strand Pattern	Strand Area(in ²)	Clear Span (Feet)											
		30	32	34	36	38	40	42	44	46	48	50	52
12S108-1.75	1.530	302	280	245	213	185	160	138	119	102	87	74	63
12S88-1.75	1.224	261	223	191	164	141	121	105	89	74	62	-	-
12S68-1.75	0.918	187	158	133	112	95	80	67	-	-	-	-	-
12S48-1.75	0.612	110	89	72	58	-	-	-	-	-	-	-	-

Estimated Camber at Time of Erection (inches)

Strand Pattern	Strand Area(in ²)	Clear Span (Feet)											
		30	32	34	36	38	40	42	44	46	48	50	52
12S108-1.75	1.530	1.01	1.07	1.12	1.15	1.16	1.14	1.08	1.00	0.87	0.69	0.46	0.18
12S88-1.75	1.224	0.71	0.73	0.74	0.72	0.68	0.61	0.50	0.36	0.17	-0.07	-	-
12S68-1.75	0.918	0.41	0.40	0.36	0.30	0.21	0.08	-0.08	-	-	-	-	-
12S48-1.75	0.612	0.12	0.06	-0.02	-0.13	-	-	-	-	-	-	-	-

$A_c = 281.2 \text{ in}^2$
 $b_w = 10.875 \text{ in}$
 $I_g = 5196 \text{ in}^4$
 $y_b = 6.09 \text{ in}$
 $w_t = 73 \text{ psf}$
 $f'_{ci} = 5000 \text{ psi}$
 $f'_c = 7000 \text{ psi}$
 $f_{pu} = 270 \text{ ksi}$

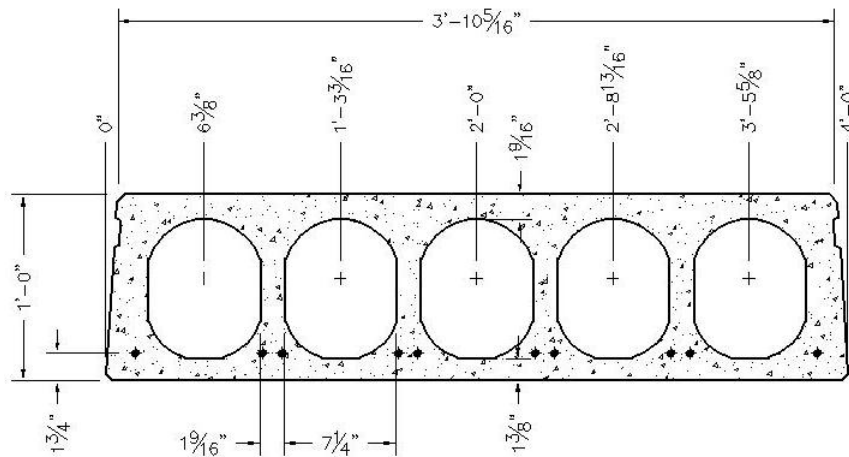

Notes:

1. Tabulated safe uniform distributed loads in this table are based on ACI 318-02/318R-02.
2. All calculated loads are considered as superimposed live load based on 1.2DL + 1.6LL.
3. Topping weight is not included in tabulated values. Size and location of openings may effect table capacity.
4. All prestressing strand is stressed to 70% of f_{pu} .
5. Tabulated loads in the shaded region have live load deflections greater than $L/360$.
6. Plank is 1 hour fire rated per IBC 2003. For higher ratings please contact KP.
7. For longer spans or conditions not covered by this table please contact KP.



1330 Chicago Drive, Jenison, Michigan 49428
 616.224.6176 616.224.2651 www.kerkstra.com



ENG:
PLANT:
FIELD:
PRES:

12" LIGHT CROSS SECTION ELEMATIC HOLLOW CORE PLANK	
DATE: 1/12/10	FILE NAME: 1405