

Maximum Uniformly Distributed Service Load (psf)

Strand Pattern	Strand Area(in ²)	Clear Span (Feet)																				
		15	16	17	18	19	20	21	22	23	24	25	26	27	28	29	30	31	32	33	34	35
8S78-1.75	1.071	311	287	267	249	232	218	205	193	182	172	163	151	136	129	123	118	109	100	91	83	76
8S58-1.75	0.765	299	276	256	239	223	209	196	178	159	142	128	115	103	93	84	76	68	61	-	-	-
8S48-1.75	0.612	293	271	251	224	196	173	153	135	120	107	95	85	75	67	-	-	-	-	-	-	-

Estimated Camber at Time of Erection (inches)

Strand Pattern	Strand Area(in ²)	Clear Span (Feet)																				
		15	16	17	18	19	20	21	22	23	24	25	26	27	28	29	30	31	32	33	34	35
8S78-1.75	1.071	0.41	0.45	0.50	0.54	0.58	0.62	0.66	0.69	0.72	0.74	0.76	0.77	0.77	0.77	0.75	0.72	0.68	0.63	0.56	0.48	0.38
8S58-1.75	0.765	0.27	0.30	0.32	0.34	0.36	0.37	0.39	0.39	0.39	0.39	0.37	0.35	0.32	0.28	0.23	0.17	0.09	0.00	-	-	-
8S48-1.75	0.612	0.20	0.22	0.23	0.24	0.25	0.25	0.25	0.24	0.23	0.21	0.18	0.15	0.10	0.04	-	-	-	-	-	-	-

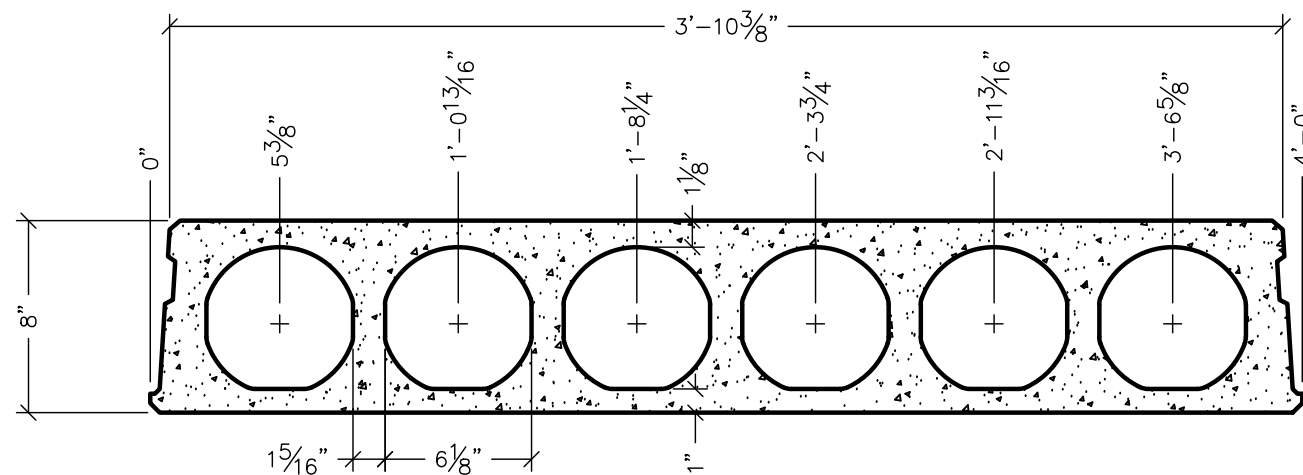

PROPERTIES

- A_c = 195.5 SQ. IN.
- I_g = 1586 IN.⁴
- Y_b = 4.08 IN.
- b_w = 10.19 IN.
- w_t = 53 PSF
- f'_{ci} = 4000psi
- f'_c = 7000psi
- f_{pu} = 270 ksi LOW LAX

NOTES:

1. TABULATED SAFE UNIFORM DISTRIBUTED LOADS IN THIS TABLE ARE BASED ON ACI 318-11/318R-02.
2. ALL CALCULATED LOADS ARE CONSIDERED AS SUPERIMPOSED LIVE LOAD BASED ON 1.2DL + 1.6LL.
3. TOPPING WEIGHT IS NOT INCLUDED IN TABULATED VALUES. SIZE AND LOCATION OF OPENINGS REDUCE TABLE CAPACITY.
4. ALL PRESTRESSING STRAND IS STRESSED TO 60-70% OF FPU TYPICAL.
5. TABULATED LOADS IN THE SHADED REGION HAVE LIVE LOAD DEFLECTIONS GREATER THAN L/360.
6. PLANK IS 1.5 HOUR FIRE RATED PER PCI MNL-124. FOR HIGHER RATINGS PLEASE CONTACT KP.
7. FOR LONGER SPANS OR CONDITIONS NOT COVERED BY THIS TABLE PLEASE CONTACT KP.
8. LOADS TO THE LEFT OF THE HEAVY LINE ARE GOVERNED BY SHEAR CAPACITY.