

Maximum Uniformly Distributed Service Load (psf)

Strand pattern	Clear Span (ft)																
	40	42	44	46	48	50	52	54	56	58	60	62	64	66	68	70	72
089-S	160	140	125	110	95	85	75	65	55	50							
109-S	200	175	155	140	120	110	95	85	75	70	60	55	50	40			
129-S	230	205	185	165	145	130	115	105	95	85	75	65	60	55	45	40	35
*149-S		235	210	185	165	150	135	120	110	100	90	80	70	65	55	50	45
*169-S			230	205	185	165	150	135	120	110	100	90	80	75	65	60	55

Estimated 28-Day Camber (in.)

Strand pattern	Clear Span (ft)																
	40	42	44	46	48	50	52	54	56	58	60	62	64	66	68	70	72
089-S	0.68	0.71	0.74	0.77	0.78	0.79	0.79	0.78	0.75	0.72	0.67						
109-S	0.82	0.87	0.92	0.96	0.99	1.02	1.04	1.04	1.04	1.02	0.99	0.95	0.89	0.81			
129-S	0.94	1.00	1.06	1.11	1.16	1.20	1.23	1.26	1.27	1.27	1.26	1.23	1.19	1.13	1.05	0.95	0.83
*149-S		1.10	1.17	1.23	1.29	1.34	1.38	1.42	1.44	1.45	1.46	1.44	1.41	1.37	1.30	1.22	1.11
*169-S			1.24	1.31	1.38	1.43	1.48	1.53	1.56	1.58	1.59	1.59	1.57	1.53	1.48	1.40	1.31

$A_g = 667 \text{ in}^2$ $I_x = 63484 \text{ in}^4$
 $y_b = 22.66 \text{ in}$ $w_{sw} = 694 \text{ plf}$
 $f'_{ci} = 4000 \text{ psi}$ $f'_c = 6000 \text{ psi}$
 Strand: 9/16" \varnothing Pulled to 70%

* = Release strength of greater than 4000 psi required for this strand pattern.

Notes:

1. Tabulated uniform distributed loads in this table are based on ACI 318-05/318R-05.
2. All calculated loads are considered as superimposed live load based on 1.2DL + 1.6LL.
3. Double Tee is 1½ hour fire rated per IBC 2006. For higher ratings please contact KP.
4. For longer spans or conditions not covered by this table please contact KP.

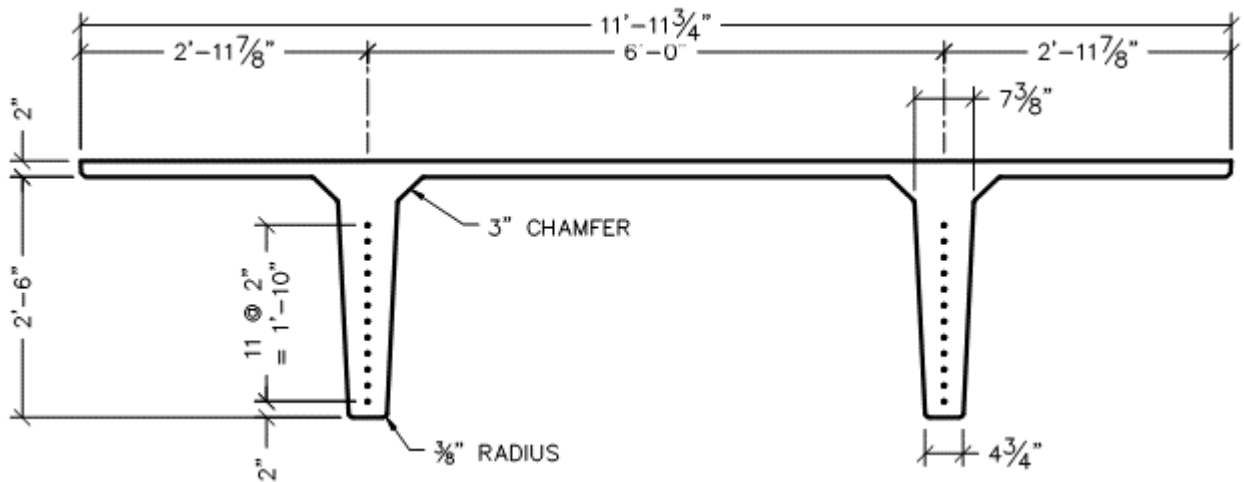

12DT32

12' WIDE DOUBLE TEE – 32" UNTOPPED

DATE:

1/23/16

FILE NAME:

3630



3373 Buech Drive, Grandville, Michigan 49418
 616.224.8176 > t:616.224.2551 > www.kerkstra.com >

