

Maximum Uniformly Distributed Service Load (psf)

Strand pattern	Clear Span (ft)																
	40	42	44	46	48	50	52	54	56	58	60	62	64	66	68	70	72
089-S	160	140	120	105	90	80	65	55	50	40	35						
109-S	205	180	160	140	125	110	95	85	70	65	55	45	40	35			
129-S	245	215	190	170	150	135	120	105	90	80	70	65	55	45	40		
*149-S		250	220	195	175	155	140	125	110	100	85	75	70	60	50	45	40
*169-S			245	220	195	175	155	140	125	110	100	90	80	70	65	55	50

Estimated 28-Day Camber (in.)

Strand pattern	Clear Span (ft)																
	40	42	44	46	48	50	52	54	56	58	60	62	64	66	68	70	72
089-S	0.54	0.56	0.57	0.58	0.57	0.56	0.53	0.50	0.44	0.38	0.30						
109-S	0.68	0.72	0.74	0.76	0.78	0.78	0.77	0.75	0.72	0.68	0.62	0.54	0.44	0.32			
129-S	0.80	0.85	0.89	0.92	0.95	0.97	0.98	0.97	0.96	0.93	0.89	0.83	0.75	0.65	0.53		
*149-S		0.96	1.01	1.06	1.09	1.12	1.15	1.16	1.15	1.14	1.11	1.07	1.00	0.92	0.82	0.70	0.55
*169-S			1.10	1.16	1.21	1.25	1.28	1.30	1.31	1.30	1.29	1.25	1.20	1.14	1.05	0.94	0.80

$A_g = 954 \text{ in}^2$ $I_x = 85066 \text{ in}^4$
 $y_b = 25.81 \text{ in}$ $w_{sw} = 994 \text{ plf}$
 $f'_{ci} = 4000 \text{ psi}$ $f'_c = 6000 \text{ psi}$
 Strand: 9/16" \varnothing Pulled to 70%

* = Release strength of greater than 4000 psi required for this strand pattern.

Notes:

1. Tabulated uniform distributed loads in this table are based on ACI 318-05/318R-05.
2. All calculated loads are considered as superimposed live load based on 1.2DL + 1.6LL.
3. Double Tee is 1½ hour fire rated per IBC 2006. For higher ratings please contact KP.
4. For longer spans or conditions not covered by this table please contact KP.

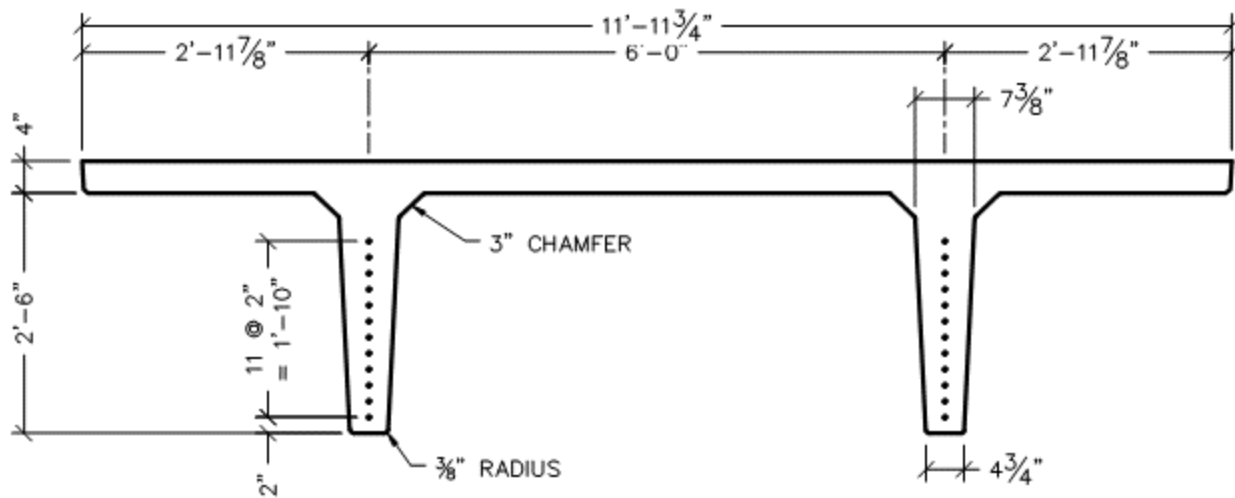

12DT32+2

12' WIDE DOUBLE TEE – 32" + 2" PRETOPPED

DATE:

1/23/16

FILE NAME:

3631



3373 Buech Drive, Grandville, Michigan 49418
 616.224.8176 > t:616.224.2851 > www.kerkstra.com >

