

Maximum Uniformly Distributed Service Load (psf)

Strand pattern	Clear Span (ft)																
	40	42	44	46	48	50	52	54	56	58	60	62	64	66	68	70	72
089-S	130	115	95	85	70	60	50	40	35	25							
109-S	165	145	125	110	95	80	70	60	50	45	35	30	25				
129-S	200	175	150	135	115	100	90	80	70	60	50	45	35	30	25		
*149-S		195	175	155	135	120	105	90	80	70	60	55	45	40	35	25	
*169-S			190	170	150	135	120	105	90	80	70	65	55	45	40	35	30

Estimated 28-Day Camber (in.)

Strand pattern	Clear Span (ft)																
	40	42	44	46	48	50	52	54	56	58	60	62	64	66	68	70	72
089-S	0.59	0.60	0.60	0.60	0.58	0.54	0.49	0.43	0.34	0.24							
109-S	0.74	0.77	0.79	0.80	0.79	0.78	0.75	0.70	0.64	0.56	0.45	0.33	0.17				
129-S	0.86	0.90	0.94	0.96	0.97	0.97	0.96	0.93	0.88	0.81	0.73	0.62	0.49	0.33	0.14		
*149-S		1.01	1.05	1.08	1.11	1.12	1.11	1.10	1.06	1.01	0.94	0.84	0.72	0.58	0.40	0.20	
*169-S			1.13	1.17	1.20	1.22	1.22	1.21	1.19	1.15	1.08	1.00	0.89	0.75	0.59	0.40	0.17

$A_g = 914 \text{ in}^2$ $I_x = 61707 \text{ in}^4$
 $y_b = 22.81 \text{ in}$ $w_{sw} = 952 \text{ plf}$
 $f'_{ci} = 4000 \text{ psi}$ $f'_c = 6000 \text{ psi}$
 Strand: 9/16" \varnothing Pulled to 70%

* = Release strength of greater than 4000 psi required for this strand pattern.

Notes:

1. Tabulated uniform distributed loads in this table are based on ACI 318-05/318R-05.
2. All calculated loads are considered as superimposed live load based on 1.2DL + 1.6LL.
3. Double Tee is 1½ hour fire rated per IBC 2006. For higher ratings please contact KP.
4. For longer spans or conditions not covered by this table please contact KP.

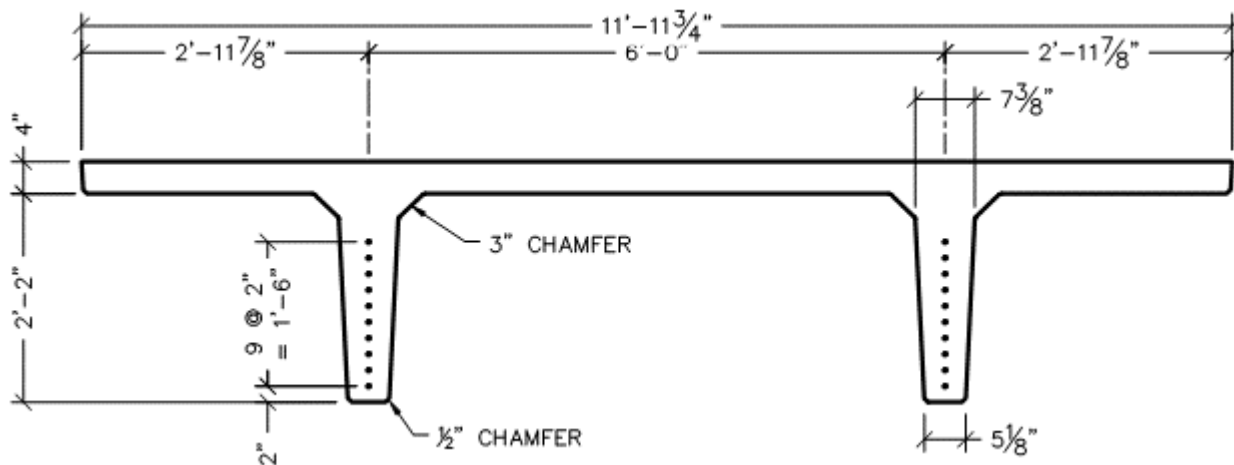

12DT28+2

12' WIDE DOUBLE TEE – 28" + 2" PRETOPPED

DATE:

1/23/16

FILE NAME:

3633



3373 Buech Drive, Grandville, Michigan 49418
 616.224.8176 > t:616.224.2551 > www.kerkstra.com >

