

**Maximum Uniformly Distributed Service Load (psf)**

Strand pattern	Clear Span (ft)																
	28	30	32	34	36	38	40	42	44	46	48	50	52	54	56	58	60
069-S	205	170	145	120	100	85	70	55	45	35							
089-S	280	235	200	170	145	125	105	90	75	65	55	45	35	30			
109-S	335	285	240	205	175	155	130	115	100	85	70	60	50	45	35	30	25
* 129-S		325	275	240	205	180	155	135	115	100	90	75	65	55	50	40	35
* 149-S			305	265	230	200	175	150	130	115	100	90	75	65	55	50	40

**Estimated 28-Day Camber (in.)**

Strand pattern	Clear Span (ft)																
	28	30	32	34	36	38	40	42	44	46	48	50	52	54	56	58	60
069-S	0.31	0.33	0.35	0.36	0.36	0.35	0.33	0.29	0.24	0.18							
089-S	0.41	0.44	0.47	0.50	0.51	0.52	0.52	0.50	0.47	0.43	0.36	0.28	0.17	0.04			
109-S	0.48	0.52	0.56	0.60	0.63	0.65	0.66	0.66	0.65	0.62	0.57	0.50	0.41	0.30	0.16	-0.01	-0.21
* 129-S		0.58	0.63	0.67	0.71	0.74	0.76	0.77	0.77	0.75	0.71	0.66	0.58	0.48	0.35	0.20	0.01
* 149-S			0.66	0.71	0.75	0.79	0.82	0.83	0.83	0.82	0.79	0.74	0.67	0.58	0.46	0.31	0.13

$A_g = 870 \text{ in}^2$        $I_x = 41980 \text{ in}^4$   
 $y_b = 19.85 \text{ in}$        $w_{sw} = 906 \text{ plf}$   
 $f'_{ci} = 4000 \text{ psi}$        $f'_c = 6000 \text{ psi}$   
 Strand: 9/16"  $\varnothing$  Pulled to 70%

\* = Release strength of greater than 4000 psi required for this strand pattern.

Notes:

1. Tabulated uniform distributed loads in this table are based on ACI 318-05/318R-05.
2. All calculated loads are considered as superimposed live load based on 1.2DL + 1.6LL.
3. Double Tee is 1½ hour fire rated per IBC 2006. For higher ratings please contact KP.
4. For longer spans or conditions not covered by this table please contact KP.

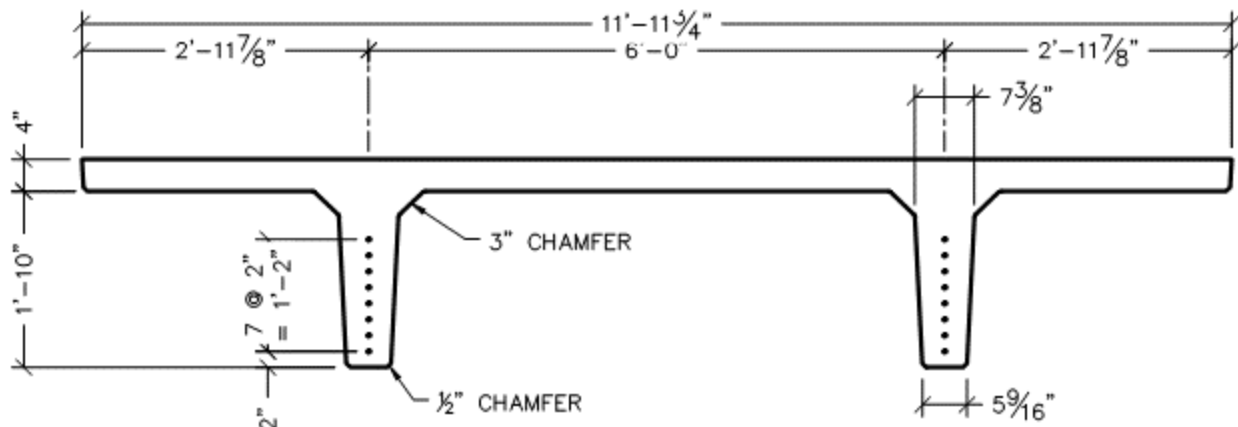

12DT24+2

12' WIDE DOUBLE TEE – 24" + 2" PRETOPPED

DATE:

1/23/16

FILE NAME:

3635



3373 Buech Drive, Grandville, Michigan 49418  
 616.224.8176 > t:616.224.2851 > www.kerkstra.com >

