

Maximum Uniformly Distributed Service Load (psf)
Clear Span (Feet)

Strand Pattern	Strand Area(in ²)	15	16	17	18	19	20	21	22	23	24	25	26	27	28	29	30	31	32	33	34	35	36	37	38	39	40	41	42	43	44	45	46	47	48	49	50
12HS8.6(28)-1.79	2.042	908	843	786	736	691	651	615	579	538	502	469	438	411	385	362	340	320	302	284	269	254	240	227	215	203	192	182	173	164	155	147	140	133	127	121	113
12HS4.6(68)-1.77	1.786	901	837	780	730	686	646	610	578	540	503	470	439	411	386	362	341	321	302	285	269	254	240	225	210	196	183	171	159	149	139	130	121	113	106	99	92
12HS6.6-1.80	1.302	851	790	736	689	647	609	575	545	494	448	407	371	339	311	285	262	241	222	205	189	174	161	149	137	127	117	108	100	92	-	-	-	-	-	-	
12HS4.6(28)-1.79	1.174	848	787	734	686	644	606	543	489	441	400	363	331	301	276	252	231	212	195	179	165	152	139	128	118	109	100	92	-	-	-	-	-	-	-	-	
12HS68-1.75	0.918	842	766	671	591	523	466	416	373	335	302	273	247	224	204	185	169	154	140	128	116	106	96	-	-	-	-	-	-	-	-	-	-	-	-	-	

Estimated Camber at Time of Erection (inches)
Clear Span (Feet)

Strand Pattern	Strand Area(in ²)	15	16	17	18	19	20	21	22	23	24	25	26	27	28	29	30	31	32	33	34	35	36	37	38	39	40	41	42	43	44	45	46	47	48	49	50
12HS8.6(28)-1.79	2.042	0.40	0.45	0.50	0.55	0.61	0.66	0.72	0.77	0.83	0.89	0.94	1.00	1.05	1.10	1.15	1.19	1.24	1.28	1.31	1.34	1.37	1.39	1.40	1.40	1.40	1.39	1.38	1.35	1.31	1.26	1.20	1.13	1.05	0.95	0.84	0.71
12HS4.6(68)-1.77	1.786	0.35	0.39	0.43	0.48	0.52	0.57	0.61	0.66	0.71	0.75	0.80	0.84	0.88	0.92	0.95	0.99	1.01	1.04	1.06	1.07	1.08	1.08	1.08	1.07	1.05	1.02	0.99	0.94	0.88	0.81	0.73	0.64	0.54	0.42	0.28	0.13
12HS6.6-1.80	1.302	0.24	0.27	0.30	0.33	0.35	0.38	0.41	0.44	0.46	0.49	0.51	0.53	0.54	0.55	0.56	0.57	0.57	0.56	0.55	0.54	0.51	0.48	0.45	0.40	0.35	0.28	0.21	0.12	0.03	-	-	-	-	-	-	
12HS4.6(28)-1.79	1.174	0.21	0.24	0.26	0.29	0.31	0.34	0.36	0.38	0.40	0.42	0.43	0.45	0.46	0.46	0.47	0.46	0.46	0.45	0.43	0.40	0.37	0.33	0.29	0.23	0.17	0.10	0.01	-	-	-	-	-	-	-	-	
12HS68-1.75	0.918	0.16	0.18	0.20	0.21	0.23	0.24	0.26	0.27	0.28	0.28	0.29	0.29	0.29	0.28	0.27	0.25	0.23	0.21	0.17	0.13	0.09	0.03	-	-	-	-	-	-	-	-	-	-	-	-	-	-

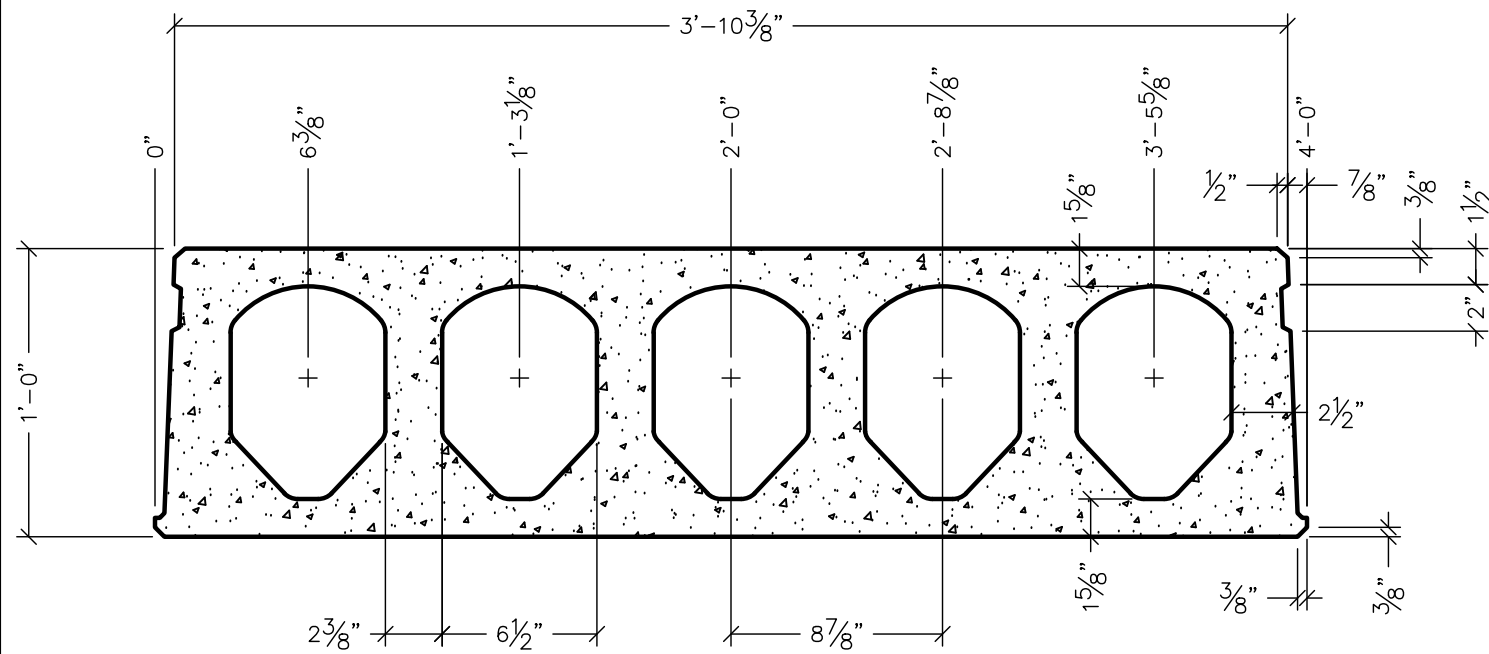

SECTION PROPERTIES

$A_c = 322.3 \text{ IN.}^2$
 $I_g = 5209 \text{ IN.}^4$
 $Y_b = 5.78 \text{ IN.}$
 $b_w = 14.625 \text{ IN.}$
 $v/s = a/p = 2.70$
 $w_t = 87 \text{ PSF}$
 $w_{\text{COREFILL}} = 50 \text{ PLF}$

CONCRETE

PLANK
 $f'_{ci} = 5000 \text{ psi}$
 $f'_c = 9000 \text{ psi}$
COREFILL
 $f'_c = 5000 \text{ psi}$

STRAND

$f_{pu} = 270 \text{ ksi (LOW LAX)}$
JACKING FORCE:
 TOP = $0.60 f_{pu}$
 BOTTOM = $0.70 f_{pu}$

NOTES:

- TABULATED SAFE UNIFORM DISTRIBUTED LOADS IN THIS TABLE ARE BASED ON ACI 318-11/318R-02.
- ALL CALCULATED LOADS ARE CONSIDERED AS SUPERIMPOSED LIVE LOAD BASED ON 1.2DL + 1.6LL.
- TOPPING WEIGHT IS NOT INCLUDED IN TABULATED VALUES.
- SIZE AND LOCATION OF OPENINGS REDUCE TABLE CAPACITY.
- TABULATED LOADS IN THE SHADED REGION HAVE LIVE LOAD DEFLECTIONS GREATER THAN L/360.
- LOADS TO THE LEFT OF THE HEAVY LINE ARE GOVERNED BY SHEAR CAPACITY.
- PLANK IS 1.5 HOUR FIRE RATED PER PCI MNL-124. FOR HIGHER RATINGS PLEASE CONTACT KP.
- FOR LONGER SPANS OR CONDITIONS NOT COVERED BY THIS TABLE PLEASE CONTACT KP.